

FOR LEASE
25,000 SF on 1.55 Acres



Building 1: 13710 Ramona Avenue, Chino, CA

FEATURES

- Main Office:** ±3,196 SF
- Clearance:** 20' Minimum
- Sprinklers:** .45 GPM/3,000 SF
- Power:** 400 Amp, 277/480 Volts, 3 Phase
- Loading:** 4 DH Loading Positions
 - 1-w/ Push Button Hydraulic Leveler & Seal
 - 1 Ground Level Ramp
- Parking:** To Code
- Lighting:** T-5 Fluorescent Fixtures

Part of a 5 Million SF Master Planned Business Park

Adjacent to Chino Valley (71) Fwy With Access to O.C. via Riverside (91) Fwy & L.A./Ontario via Pomona (60) Fwy

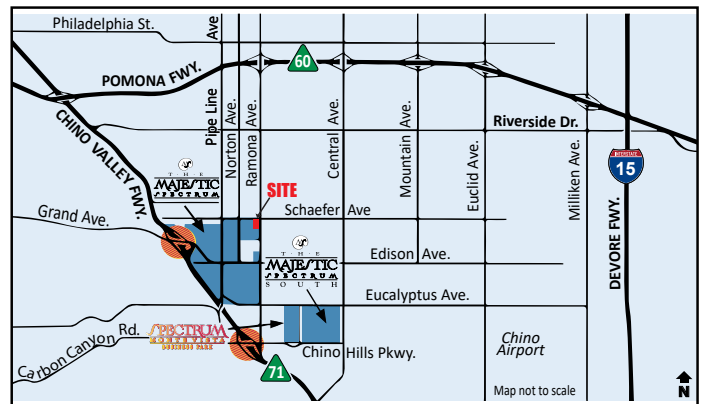

13191 Crossroads Parkway North, 6th Floor, City of Industry, CA 91746
 (562) 692-9581 | www.majesticrealty.com | R.E. License #00255328 (CA)

Mitch Embrey
 (562) 654-2726
 membrey@majesticrealty.com
 R.E. License #02058837 (CA)

Trent Wylde
 (562) 948-4315
 twylde@majesticrealty.com
 R.E. License #01180856 (CA)

Building 1 / Site Plan

25,000 Square Feet

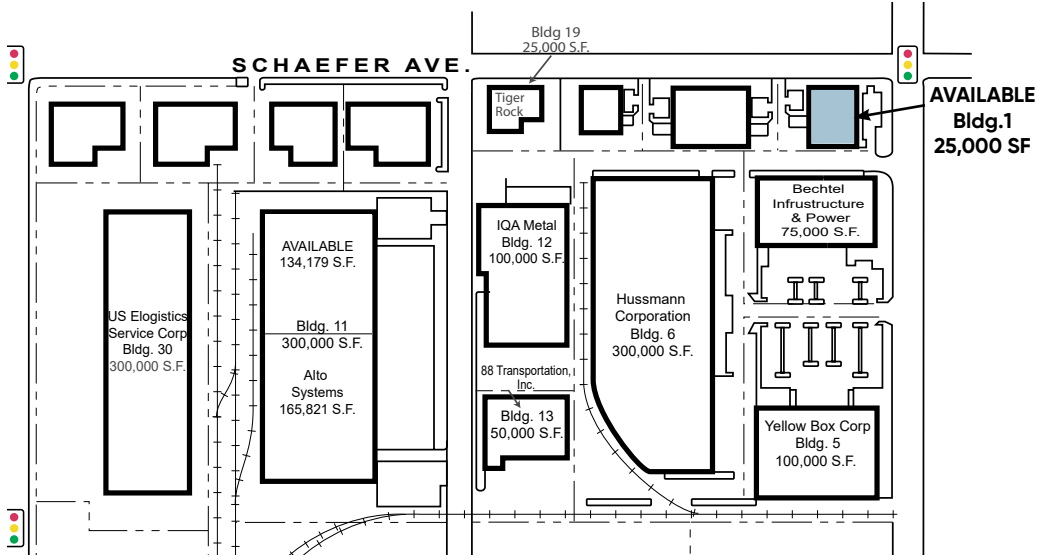
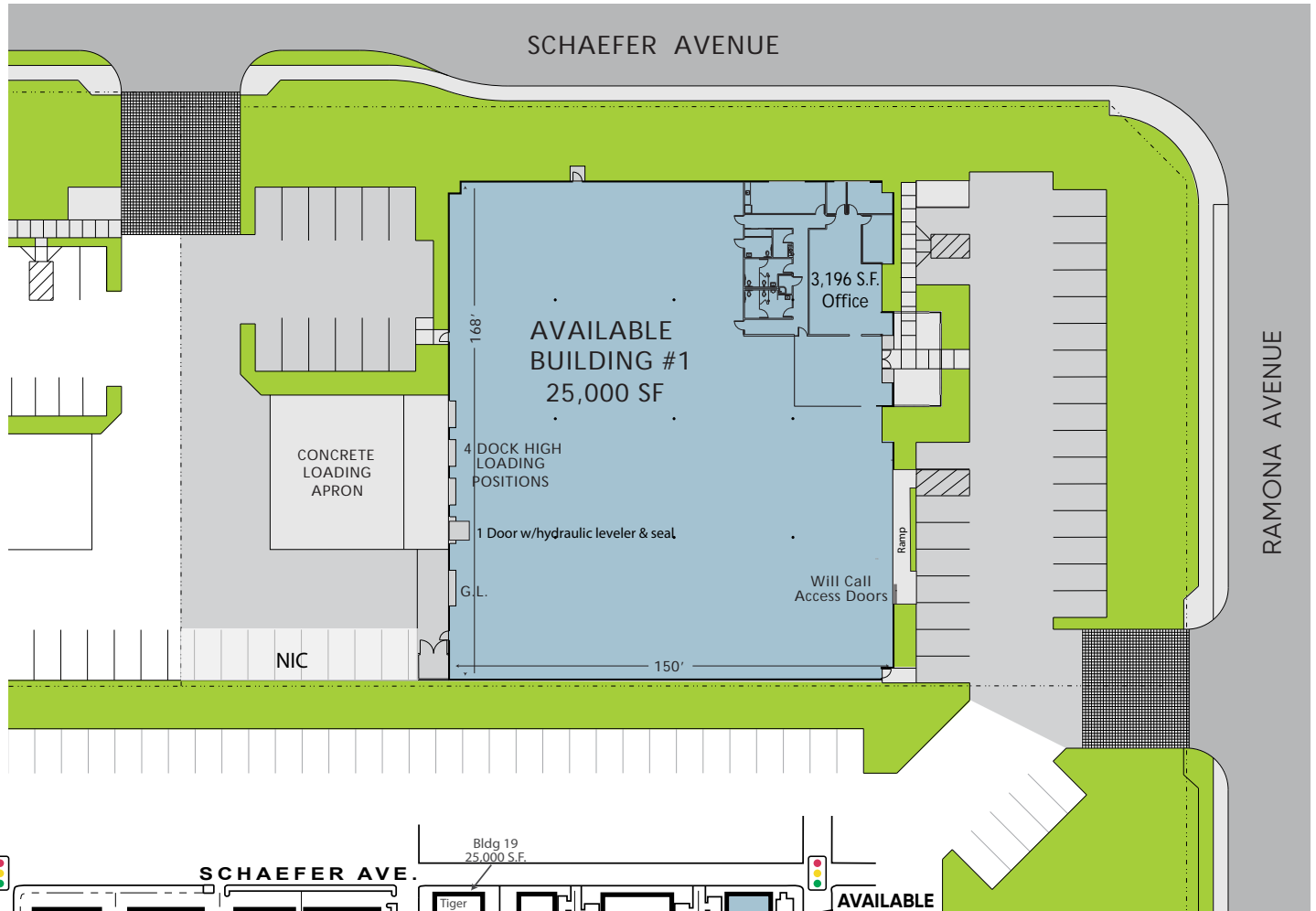

Mitch Embrey
 (562) 654-2726
 membrey@majesticrealty.com
 R.E. License #02058837 (CA)

Trent Wylde
 (562) 948-4315
 twylde@majesticrealty.com
 R.E. License #01180856 (CA)

