

**BUILDING #12**

**461,832 SF - CROSS DOCK**

**| DIVISIBLE TO 113,000 SF**

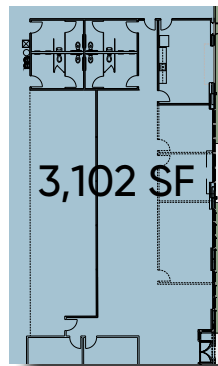
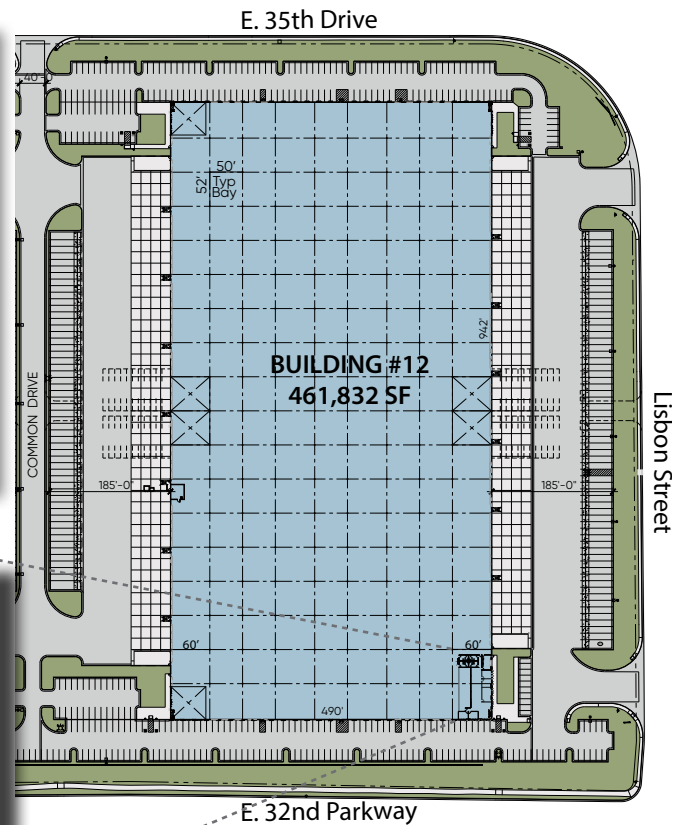

### Majestic Commercenter Features

- 1,600 Acre Master Planned Business Park
- 10 Million Square Feet Developed
- 20,000 to 1,500,000 Square Feet Available
- Spec Product and Build-to-Suit
- Immediate Access to I-70 at Tower Road
- I-70 and E-470 Frontage
- 5 miles South of Denver International Airport
- Federal Opportunity Zone
- Adams County Enterprise Zone
- Foreign Trade Zone 293
- Xcel Energy Certified Site

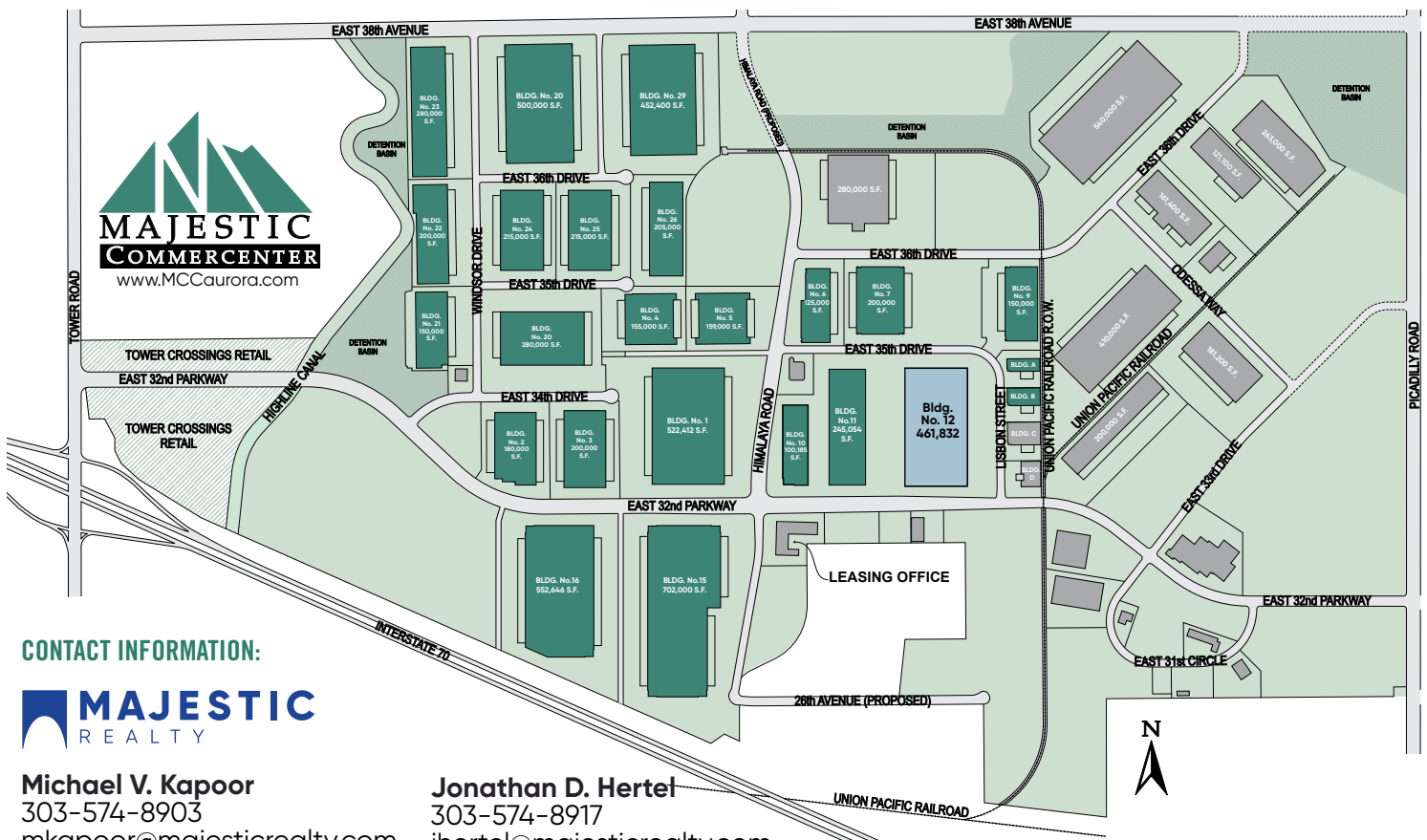

### CONTACT INFORMATION:



**Michael V. Kapoor**  
 303-574-8903  
 mkapoor@majesticrealty.com

**Jonathan D. Hertel**  
 303-574-8917  
 jhertel@majesticrealty.com