



T · H · E  
**MAJESTIC**  
 S P E C T R U M

**BUILDING #15**

**199,373 SF (P.O.L. 350,000 SF)**



**FEATURES:**

- Office:** Approx. 1,050 SF
- Clearance:** 30' at First Column
- Sprinklers:** ESFR w/ K-17 Heads
- Power:** 1,200 Amp, 277/480 Volts, 3 Phase
- Loading:** 36 DH Positions  
 17 w/ Pit Levelers, Trailer Restraints & Dock Seals  
 1 GL Ramp
- Lighting:** LED w/ Motion Sensors
- Truck Court:** Fully Secured (Shared)
- Parking:** To Code
- Rail Doors:** 9
- Bay Spacing:** 52' x 40'

4371 Edison Avenue, Chino, CA



Part of a 5 Million SF Master Planned Business Park  
 Adjacent to Chino Valley (71) Fwy With Access to O.C. via Riverside (91) Fwy & L.A./Ontario via Pomona (60 Fwy)

For Additional Information:

**MITCH EMBREY** (562) 654-2726 [membrey@majesticrealty.com](mailto:membrey@majesticrealty.com)  
 R.E. License #02058837 (CA)

**TRENT WYLDE** (562) 948-4315 [twylde@majesticrealty.com](mailto:twylde@majesticrealty.com)  
 R.E. License #01180856 (CA)



  
 T · H · E  
**MAJESTIC**  
 S P E C T R U M

4371 Edison Avenue, Chino, CA

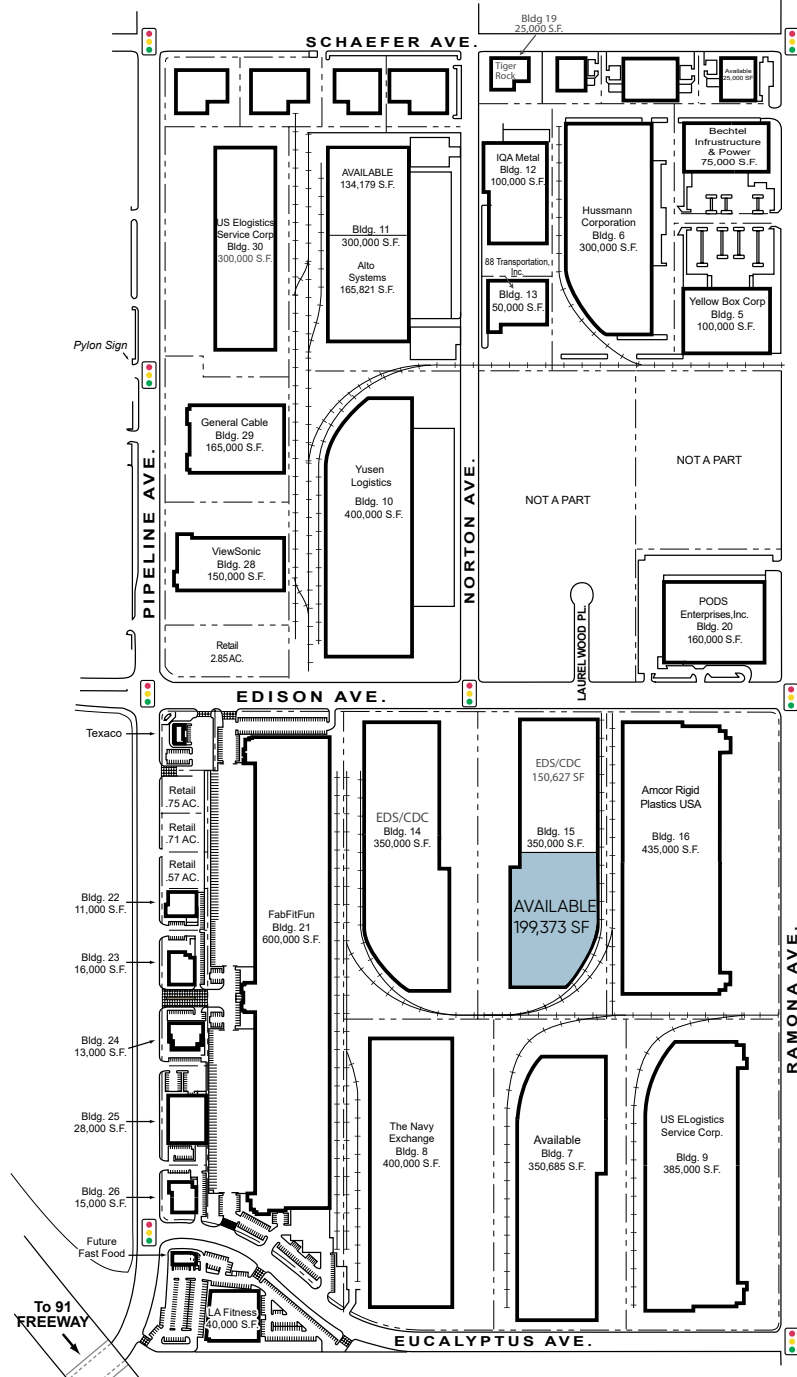
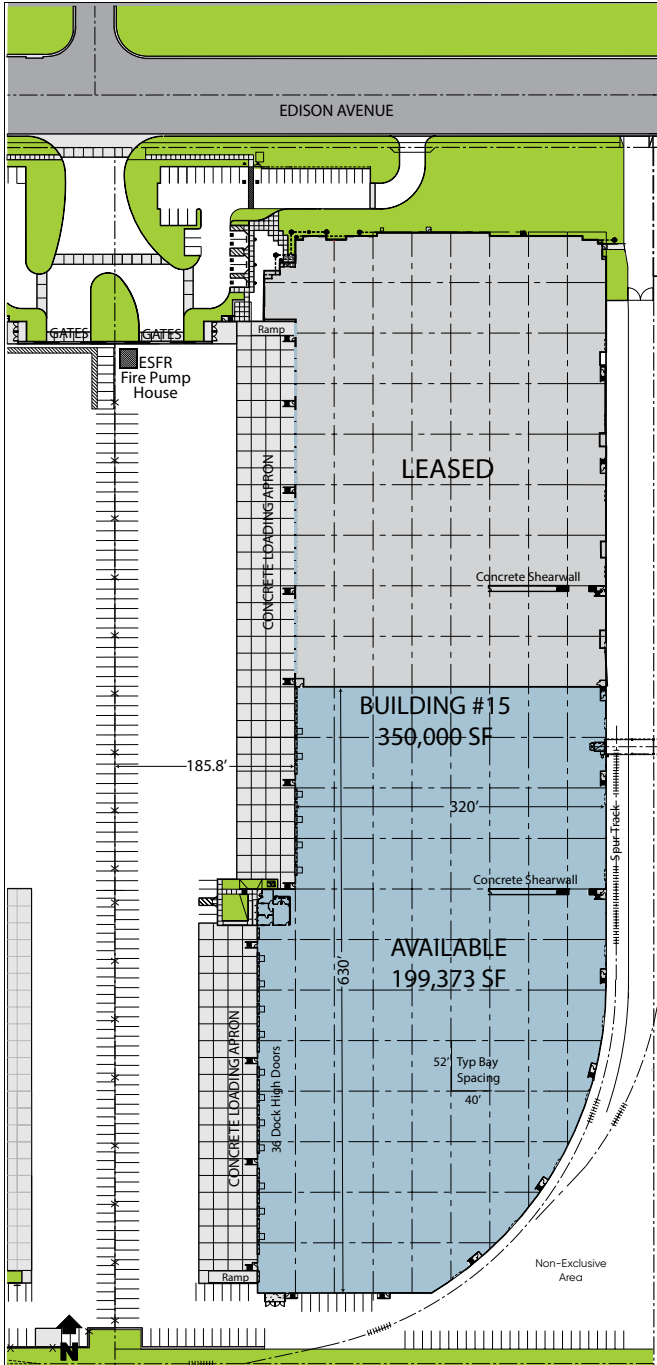

For Additional Information:



13191 Crossroads Parkway North, 6th Floor, City of Industry, CA 91746  
 (562) 692-9581 | www.majesticrealty.com | R.E. License #00255328 (CA)

**MITCH EMBREY** (562) 654-2726

R.E. License #02058837 (CA)  
 membrey@majesticrealty.com

**TRENT WYLDE** (562) 948-4315

R.E. License #01180856 (CA)  
 twylde@majesticrealty.com