

Majestic Airport Center - Ontario @ CCC IV

FOR LEASE

115,000 SF on 6.22 Acres



Building 2: 3690 E. Jurupa Street, Ontario, CA

FEATURES

- Office:** 3,585 S.F.
- Clearance:** 28' at First Column
- Sprinkler System:** ESFR w/ Redundant Support Pumping Station
- Loading:**
 - 30 - Dock High Doors w/ Vision Panels
 - 10 w/ Pit-Levelers, Z-Guards & Swing Arm Dock Lights
 - 20 w/ Edge-of-Dock Levelers
 - 9 w/ Dock Seals
 - 2 - Ground Level Doors w/ Ramps To Code
- Parking:** To Code
- Bay Spacing:** 50' x 52'
- Power:** 1- 800 Amp, 277/480 Volts, 3 Phase
- Lighting:** 4 Lamp, T-5 Fluorescent w/ Motion Sensors

Adjacent to Ontario International Airport

Immediate Access to the Pomona (60), Ontario (15) and San Bernardino (10) Freeways

Optional Activation of the Port of Long Beach Foreign Trade Zone 50-1



13191 Crossroads Parkway North, 6th Floor, City of Industry, CA 91746
(562) 692-9581 | www.majesticrealty.com | R.E. License #00255328 (CA)

Mitch Embrey
(562) 654-2726
membrey@majesticrealty.com
R.E. License #02058837 (CA)

Trent Wylde
(562) 948-4315
twylde@majesticrealty.com
R.E. License #01180856 (CA)

Majestic Airport Center - Ontario @ CCC IV

FOR LEASE

115,000 SF on 6.22 Acres

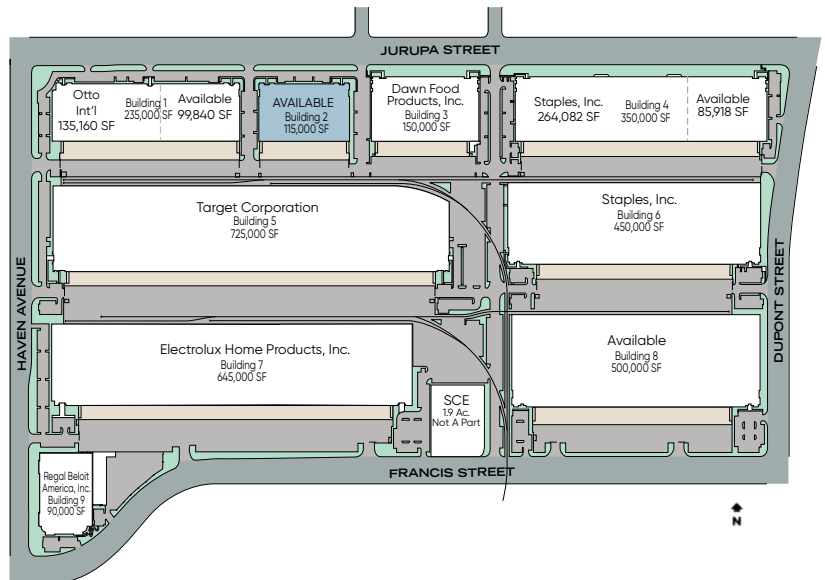
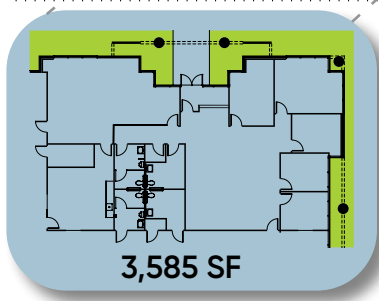
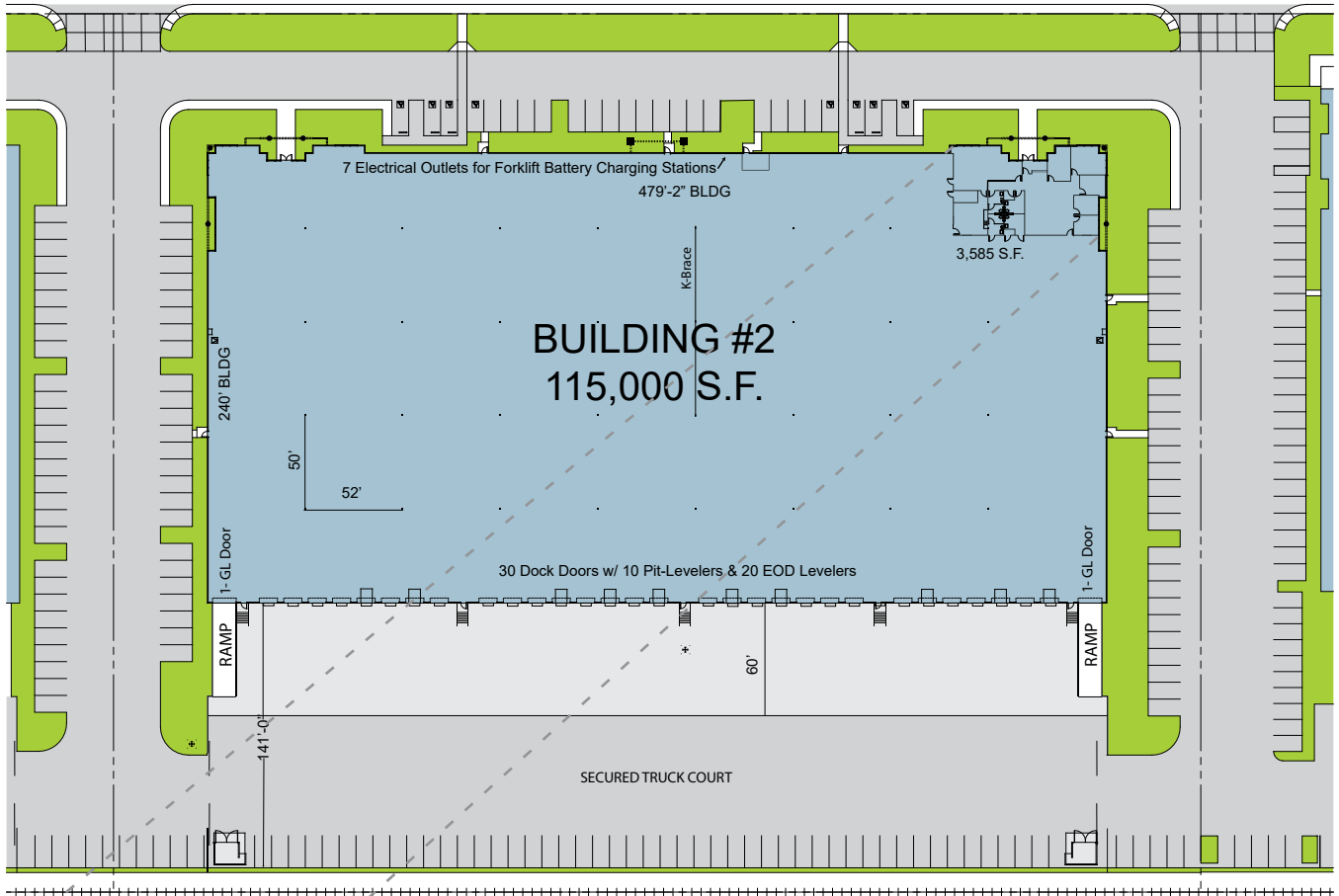

Mitch Embrey
 (562) 654-2726
 membrey@majesticrealty.com
 R.E. License #02058837 (CA)

Trent Wylde
 (562) 948-4315
 twylde@majesticrealty.com
 R.E. License #01180856 (CA)